

The New, Modular SENTRON 3NP1 Fuse Switch Disconnectors

Efficient, safe and flexible



Highlights

- Maximum flexibility thanks to modular design and integrated accessories
- Easy and rapid mounting
- Reduced expenditure and space requirements thanks to compact size
- Fast and safe modification for cable feeder top / bottom
- Increased personnel and system protection
- Flexible switching times of the auxiliary switch possible (simultaneous or leading)

SENTRON

Answers for industry.

SIEMENS

SETRON 3NP1 Fuse Switch Disconnectors

Portfolio Overview

	Size	Flat connector				Box terminal			
		Basic device	MFM	EFM 10	EFM 20/25	Basic device	MFM	EFM 10	EFM 20/25
Floor mounting	NH000					✓		✓	✓
	NH00	✓	✓	✓	✓	✓	✓	✓	✓
	NH1	✓	✓	✓	✓	✓	✓	✓	✓
	NH2	✓	✓	✓	✓	✓	✓	✓	✓
	NH3	✓	✓	✓	✓	✓	✓	✓	✓
40 mm busbar system	NH000					✓		✓	✓
	NH00	✓	✓	✓	✓	✓	✓	✓	✓
	NH1								
	NH2								
	NH3								
60 mm busbar system	NH000					✓		✓	✓
	NH00	✓	✓	✓	✓	✓	✓	✓	✓
	NH1	✓	✓	✓	✓	✓	✓	✓	✓
	NH2	✓	✓	✓	✓	✓	✓	✓	✓
	NH3	✓	✓	✓	✓	✓	✓	✓	✓

MFM – electromechanical fuse monitoring

EFM – electronic fuse monitoring

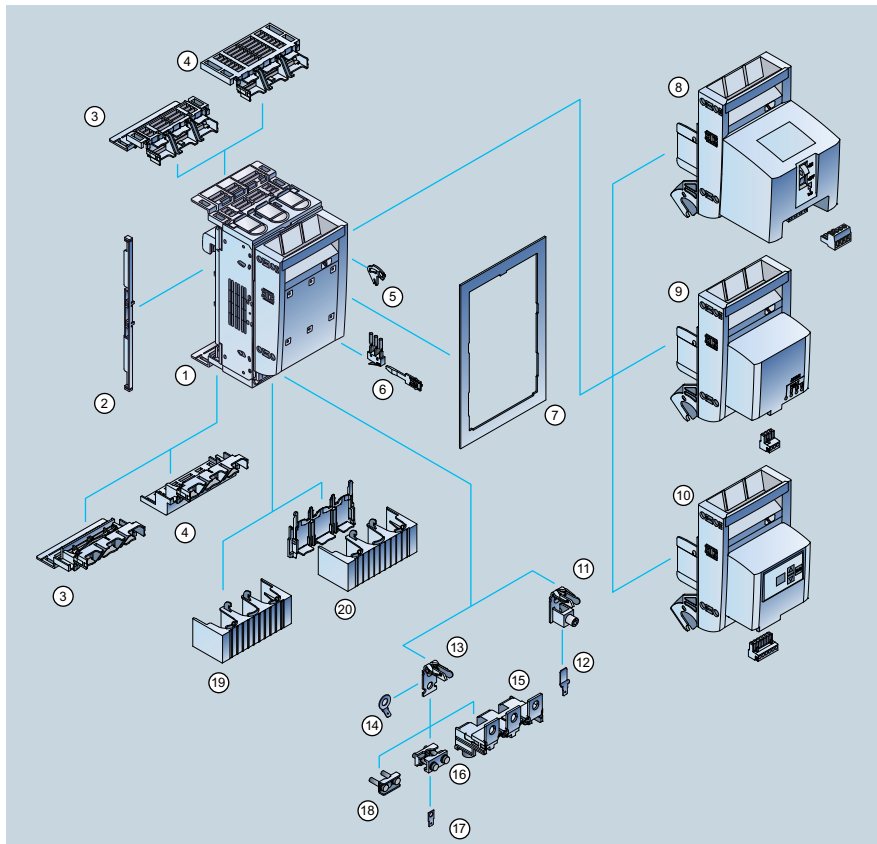

The new member of the SETRON range – the efficient SETRON 3NP1 fuse switch disconnector for maximum system availability.

Unique: One device version for use in both industry and infrastructure applications facilitates selection and ordering for differing application cases.

Furthermore, the integrated and comprehensive range of accessories supports easy and rapid mounting.

- ① SETRON 3NP1 fuse switch disconnector
- ② Frame support
- ③ Touch protection protection for Siemens busbar system
- ④ Touch protection protection for Rittal busbar system
- ⑤ Locking device
- ⑥ Auxiliary switch with actuator
- ⑦ Molded-plastic masking frame
- ⑧ Handle unit with electromechanical fuse monitoring (MFM)
- ⑨ Handle unit with electronic fuse monitoring (EFM 10)
- ⑩ Handle unit with electronic fuse monitoring (EFM 20/25)
- ⑪ Box terminal
- ⑫ Auxiliary conductor connection for box terminal
- ⑬ Flat connector
- ⑭ Auxiliary conductor connection for flat connector
- ⑮ Terminal module
- ⑯ Prism terminal
- ⑰ Auxiliary conductor connection for prism terminal
- ⑱ Saddle terminal
- ⑲ Cable connection cover
- ⑳ Cable connection cover with rear touch protection

3NP1 Fuse Switch Disconnectors up to 630 A



Floor mounting					
Rated current in A	For NH fuse links in acc. with DIN 43620	Connection	Conductor cross-section mm ²	Order No.	
160	000	Box terminal	1,5 - 50	3NP1123-1CA20	
160	00 / 000	Flat connector	1x 2,5 - 95 (M8) 2x 2,5 - 70 (M8)	3NP1133-1CA10	
160	00 / 000	Box terminal	6 - 70	3NP1133-1CA20	
250	1 und 0	Flat connector	1x 16 - 150 (M10) 2x 16 - 95 (M10)	3NP1143-1DA10	
250	1 und 0	Box terminal	70 - 185	3NP1143-1DA20	
400	2 und 1	Flat connector	1x 25 - 240 (M12) 2x 25 - 150 (M12)	3NP1153-1DA10	
400	2 und 1	Box terminal	120 - 300	3NP1153-1DA20	
630	3 und 2	Flat connector	1x 50 - 300 (M12) 2x 50 - 240 (M12)	3NP1163-1DA10	
630	3 und 2	Box terminal	120 - 300	3NP1163-1DA20	



40 mm busbar system					
Rated current in A	For NH fuse links in acc. with DIN 43620	Connection	Conductor cross-section mm ²	Order No.	
160	000	Box terminal	1,5 - 50	3NP1123-1BB20	
160	00 / 000	Flat connector	1x 2,5 - 95 (M8) 2x 2,5 - 70 (M8)	3NP1133-1BB10	
160	00 / 000	Box terminal	6 - 70	3NP1133-1BB20	



60 mm busbar system					
Rated current in A	For NH fuse links in acc. with DIN 43620	Connection	Conductor cross-section mm ²	Order No.	
160	000	Box terminal	1,5 - 50	3NP1123-1BC20	
160	00 / 000	Flat connector	1x 2,5 - 95 (M8) 2x 2,5 - 70 (M8)	3NP1133-1BC10	
160	00 / 000	Box terminal	6 - 70	3NP1133-1BC20	
250	1 and 0	Flat connector	1x 16 - 150 (M10) 2x 16 - 95 (M10)	3NP1143-1BC10	
250	1 and 0	Box terminal	70 - 185	3NP1143-1BC20	
400	2 and 1	Flat connector	1x 25 - 240 (M12) 2x 25 - 150 (M12)	3NP1153-1BC10	
400	2 and 1	Box terminal	120 - 300	3NP1153-1BC20	
630	3 and 2	Flat connector	1x 50 - 300 (M12) 2x 50 - 240 (M12)	3NP1163-1BC10	
630	3 and 2	Box terminal	120 - 300	3NP1163-1BC20	

Strong Partners for Industry and Trade



Accessories					
	NH000	NH00	NH1	NH2	NH3
Connection system					
Infeed terminal 16-95 mm² (1 set = 3 items)	3NP1923-1BD00	–	–	–	–
Triple terminal for box terminal 3x 2.5-16 mm² (1 set = 3 items)	3NP1923-1BE20		–	–	–
Triple terminal for flat-type terminal 3x 2.5-16 mm² (1 set = 3 items)	–	3NP1933-1BE10	–	–	–
Cover cap for 1 blank with 3-phase busbar (1 set = 20 items)	3NP1923-1BF10	–	–	–	–
3-phase busbar for 2x LV HRC 000 (1 set = 5 items)	3NP1923-1BF20	–	–	–	–
3-phase busbar for 3x LV HRC 000 (1 set = 5 items)	3NP1923-1BF30	–	–	–	–
3-phase busbar for 4x LV HRC 000 (1 set = 5 items)	3NP1923-1BF40	–	–	–	–
Link rail for 3-phase busbar (1 set = 3 items)	3NP1923-1BF50	–	–	–	–
Auxiliary conductor connection with box terminal 0.25-1 mm² (1 set = 3 items)	3NP1923-1BG40	3NP1933-1BG40	3NP1943-1BG40	3NP1953-1BG40	
Auxiliary conductor connection with flat-type terminal 0.25-1 mm² (1 set = 3 items)	–	3NP1933-1BG10	3NP1943-1BG10		
Auxiliary conductor connection with saddle or prism terminal 0.25-1 mm² (1 set = 3 items)	–	3NP1933-1BG30	3NP1943-1BG30	3NP1953-1BG30	
Saddle terminal (1 set = 3 items)					
Order number	–	3NP1933-1BA00	3NP1943-1BA00	3NP1953-1BA00	3NP1963-1BA00
Connection cross-section	–	1,5-70 mm²	70-150 mm²	120-240 mm²	150-300 mm²
Prism terminal single (1 set = 3 items)					
Order number	–	3NP1933-1BB10	3NP1943-1BB10	3NP1953-1BB10	3NP1963-1BB10
Connection cross-section	–	16-95 mm²	70-150 mm²	120-240 mm²	150-300 mm²
Prism terminal double (1 set = 3 items)					
Order number	–	–	3NP1943-1BB20	3NP1953-1BB20	3NP1963-1BB20
Connection cross-section	–	–	2x 35-70 mm²	2x 70-120 mm²	2x150-185 mm²
Terminal module for 32 mm cover section with box terminal 6-70 mm²	–	3NP1933-1BC00	–	–	–
Device covers					
Cable connection cover (only for Siemens BBS40/BBS60), (top and bottom)	3NP1923-1CB00	3NP1933-1CB00	3NP1943-1CB00	3NP1953-1CB00	3NP1963-1CB00
Frame support (1 set = 2 items)	3NP1923-1CF00	3NP1933-1CF00	3NP1943-1CF00		
Touch protection for busbars (1x top, 1x bottom)	–	3NP1933-1CA10	–	–	–
Touch protection for Rittal busbars (1x top, 1x bottom)	–	3NP1933-1CA20	–	–	–
Cable connection cover with rear touch protection	–	3NP1933-1CD00	3NP1943-1CD00	3NP1953-1CD00	3NP1963-1CD00
Molded-plastic masking frame					
Frames	3NP1923-1DA00	3NP1933-1DA00	3NP1943-1DA00	3NP1953-1DA00	3NP1963-1DA00
Dimensions (HxW)	215x130 mm	215x130 mm	375x220 mm	375x245 mm	375x290 mm
Mounting kits					
For 1 DIN rail	3NP1923-1EA00	–	–	–	–
For 2 DIN rails 125/150 mm	–	3NP1933-1EB00	3NP1943-1EB00	–	–
Auxiliary switches					
1 changeover contact	3NP1920-1FA00	3NP1930-1FA00	3NP1940-1FA00		
Handle units					
Standard	3NP1923-1GA00	3NP1933-1GA00	3NP1943-1GA00	3NP1953-1GA00	3NP1963-1GA00
With electromechanical fuse monitoring	–	3NP1933-1GB10	3NP1943-1GB10	3NP1953-1GB10	3NP1963-1GB10
With electronic fuse monitoring EFM 10	3NP1923-1GB20	3NP1933-1GB20	3NP1943-1GB20	3NP1953-1GB20	3NP1963-1GB20
With electronic fuse monitoring EFM 20	3NP1923-1GB30	3NP1933-1GB30	3NP1943-1GB30	3NP1953-1GB30	3NP1963-1GB30
With electronic fuse monitoring EFM 25	3NP1923-1GB50	3NP1933-1GB50	3NP1943-1GB50	3NP1953-1GB50	3NP1963-1GB50
Locking device					
(1 set = 10 items)	3NP1900-1HA00				

Siemens AG
Industry Sector
Low-Voltage Controls and Distribution
Partner of the electrical trade
P.O. Box 48 48
90026 NÜRNBERG
GERMANY

Subject to changes without prior notice 11/08
Order No. E20001-A930-M102-X-7600
Dispo 18101
10805938 EGCD.52.9.01 SB 11085.0
Printed in Germany
© Siemens AG 2008

www.siemens.com/sentron

The information contained in this brochure merely contain general descriptions or performance characteristics, which may not always be applicable in the described form to the specific application case or may change due to product advancement. The desired performance characteristics shall only be binding if they are expressly specified upon contract conclusion.

All product designations may be brands or product names of Siemens AG or other sub-suppliers, whose utilization by third parties for their rights may violate the rights of the owner.